

DELRAY TRAINING CENTER P.U.D. - PARCEL G

75

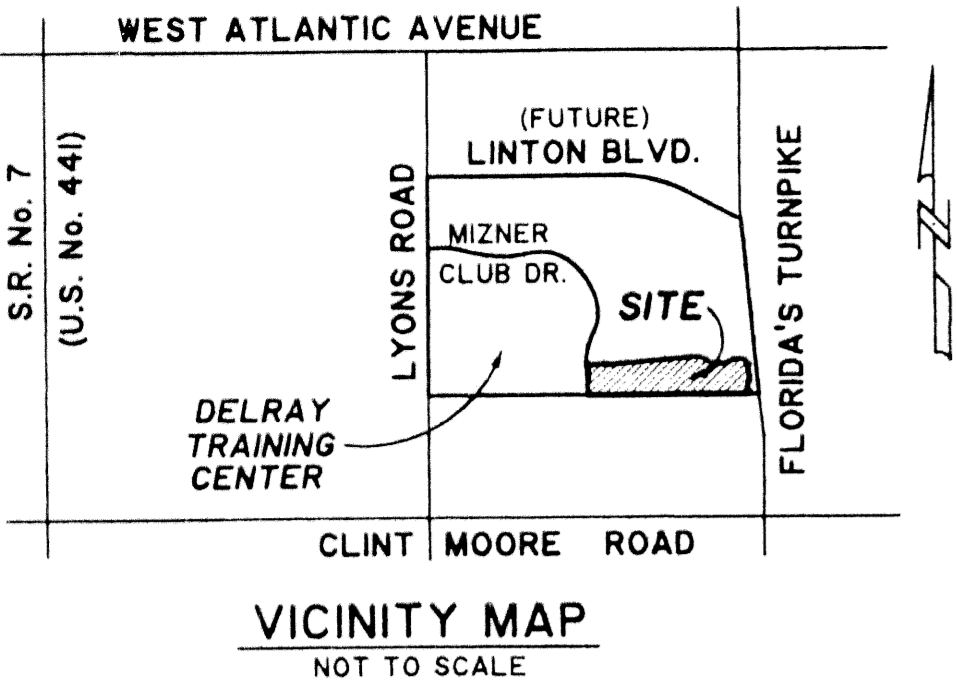

A PLANNED UNIT DEVELOPMENT
BEING A REPLAT OF TRACT "FD-3", DELRAY TRAINING CENTER - PLAT ONE, AS RECORDED IN PLAT BOOK 86, PAGES 60 THROUGH 67, PUBLIC RECORDS OF PALM BEACH COUNTY, FLORIDA, LYING IN SECTION 29, TOWNSHIP 46 SOUTH, RANGE 42 EAST, PALM BEACH COUNTY, FLORIDA.
SHEET 1 OF 3

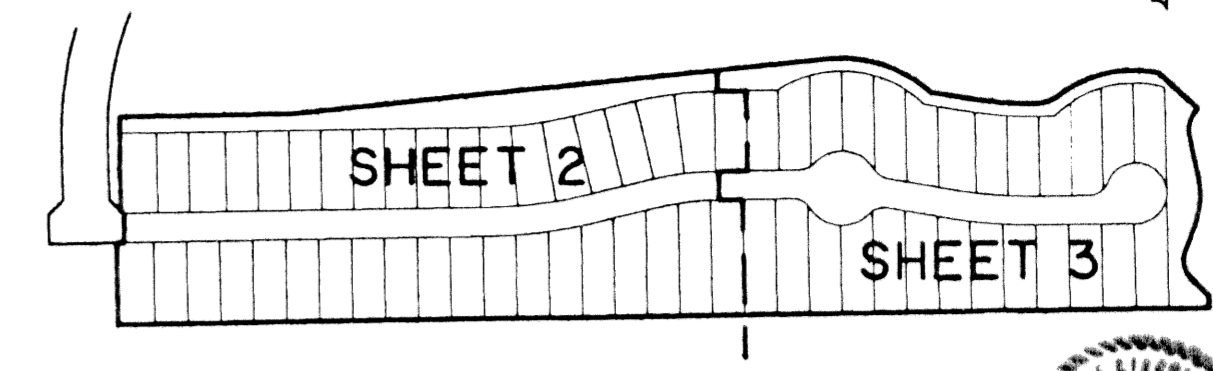

STATE OF FLORIDA
COUNTY OF PALM BEACH
THIS PLAT WAS FILED FOR RECORD AT 9:34 A.M. THIS 17th DAY OF October 2001 AND DULY RECORDED IN PLAT BOOK NO. 92 ON PAGES 75-77
DOROTHY H. WILKEN, CLERK OF THE CIRCUIT COURT
[Signature]

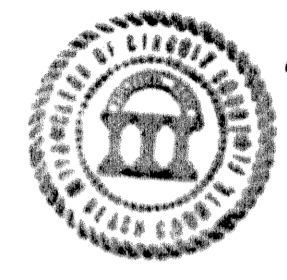

DEDICATION AND RESERVATION

KNOW ALL MEN BY THESE PRESENTS THAT TBI/PALM BEACH LIMITED PARTNERSHIP, A FLORIDA LIMITED PARTNERSHIP, OWNER OF THE LAND SHOWN HEREON AS DELRAY TRAINING CENTER P.U.D. - PARCEL G, BEING A REPLAT OF ALL OF TRACT "FD-3" ACCORDING TO DELRAY TRAINING CENTER - PLAT ONE, AS RECORDED IN PLAT BOOK 86, PAGES 60 THROUGH 67, PUBLIC RECORDS OF PALM BEACH COUNTY, FLORIDA, LYING IN SECTION 29, TOWNSHIP 46 SOUTH, RANGE 42 EAST, PALM BEACH COUNTY, FLORIDA, BEING MORE PARTICULARLY DESCRIBED AS FOLLOWS.

ALL OF TRACT "FD-3", ACCORDING TO DELRAY TRAINING CENTER - PLAT ONE, AS RECORDED IN PLAT BOOK 86, PAGES 60 THROUGH 67, INCLUSIVE, PUBLIC RECORDS OF PALM BEACH COUNTY, FLORIDA.

THE ABOVE DESCRIBED PARCEL OF LAND CONTAINS 16.75 ACRES MORE OR LESS.

HAVE CAUSED THE SAME TO BE SURVEYED AND PLATTED AS SHOWN HEREON AND DO HEREBY DEDICATE AS FOLLOWS:

1. STREETS

TRACT "S-2", AS SHOWN HEREON, IS HEREBY RESERVED FOR THE MIZNER COUNTRY CLUB MASTER ASSOCIATION, INC., ITS SUCCESSORS AND ASSIGNS, FOR PRIVATE STREET PURPOSES AND OTHER PURPOSES NOT INCONSISTENT WITH THIS RESERVATION AND IS THE PERPETUAL MAINTENANCE OBLIGATION OF SAID ASSOCIATION, ITS SUCCESSORS AND ASSIGNS, WITHOUT RECOURSE TO PALM BEACH COUNTY.

2. EASEMENTS

A PRIVATE NON-EXCLUSIVE EASEMENT IS HEREBY GRANTED TO PALM BEACH COUNTY, ITS SUCCESSORS AND ASSIGNS FOR THE PURPOSE OF INSTALLING, MAINTAINING AND REPAIRING WATER AND SEWER FACILITIES, WITHIN THE AREA DESIGNATED ON THE PLAT AS P.S.U.E. NO RIGHTS IN FAVOR OF THE PUBLIC ARE CREATED BY THIS EASEMENT.

A PRIVATE NON-EXCLUSIVE EASEMENT IS HEREBY GRANTED TO FLORIDA POWER & LIGHT SOLELY FOR THE PURPOSE OF INSTALLING, MAINTAINING AND REPAIRING UNDERGROUND FACILITIES, OTHER THAN TRANSFORMERS WHICH MAY BE ABOVE-GROUND WHERE NECESSARY, WITHIN THE AREA DESIGNATED ON THE PLAT AS P.S.U.E., TO PROVIDE ELECTRICAL SERVICE TO THE PLATTED PROPERTY. NO RIGHTS IN FAVOR OF THE PUBLIC ARE CREATED BY THIS EASEMENT.

FURTHER NON-EXCLUSIVE EASEMENTS MAY BE GRANTED OVER THE P.S.U.E., AS PROVIDED FOR IN THE DECLARATION OF RESTRICTIONS WHICH ENCUMBERS THE PROPERTY.

THE DRAINAGE EASEMENTS AS SHOWN HEREON ARE HEREBY DEDICATED IN PERPETUITY FOR DRAINAGE PURPOSES. THE MAINTENANCE OF ALL DRAINAGE FACILITIES LOCATED THEREIN SHALL BE THE PERPETUAL MAINTENANCE OBLIGATION OF THE MIZNER COUNTRY CLUB MASTER ASSOCIATION, INC., ITS SUCCESSORS AND ASSIGNS, WITHOUT RECOURSE TO PALM BEACH COUNTY.

PALM BEACH COUNTY SHALL HAVE THE RIGHT, BUT NOT THE OBLIGATION, TO MAINTAIN ANY PORTION OF THE DRAINAGE SYSTEM ENCOMPASSED BY THE PLAT WHICH IS ASSOCIATED WITH THE DRAINAGE OF PUBLIC STREETS, INCLUDING THE RIGHT TO UTILIZE FOR PROPER PURPOSES ANY AND ALL DRAINAGE, LAKE MAINTENANCE, AND LAKE MAINTENANCE ACCESS EASEMENTS AND PRIVATE STREETS ASSOCIATED WITH SAID DRAINAGE SYSTEM.

THE ROOF OVERHANG AND RECIPROCAL MAINTENANCE EASEMENTS (R.E.), AS SHOWN HEREON, ARE HEREBY DEDICATED IN PERPETUITY, INDIVIDUALLY, TO LOT OWNERS AND ASSIGNS, ABUTTING RESPECTIVE EASEMENTS FOR THE PURPOSE OF ACCESS TO, AND MAINTENANCE OF, IMPROVEMENTS, ROOF OVERHANGS, DRAINAGE AND UTILITY SERVICES WITHIN THE LOT ADJACENT TO SAID EASEMENTS, WITHOUT RECOURSE TO PALM BEACH COUNTY.

THE UTILITY EASEMENTS AS SHOWN HEREON ARE HEREBY DEDICATED IN PERPETUITY FOR THE CONSTRUCTION AND MAINTENANCE OF UTILITY FACILITIES, INCLUDING CABLE TELEVISION SYSTEMS. THE INSTALLATION OF CABLE TELEVISION SYSTEMS SHALL NOT INTERFERE WITH THE CONSTRUCTION AND MAINTENANCE OF OTHER UTILITIES.

3. TRACTS

TRACT "G", AS SHOWN HEREON, IS HEREBY RESERVED FOR THE MIZNER COUNTRY CLUB, INC., ITS SUCCESSORS AND ASSIGNS, FOR GOLF COURSE PURPOSES AND IS THE PERPETUAL MAINTENANCE OBLIGATION OF MIZNER COUNTRY CLUB, INC., ITS SUCCESSORS AND ASSIGNS, WITHOUT RECOURSE TO PALM BEACH COUNTY.

TRACTS "O-1" AND "O-2", AS SHOWN HEREON, ARE HEREBY RESERVED FOR THE MIZNER COUNTRY CLUB MASTER ASSOCIATION, INC., ITS SUCCESSORS AND ASSIGNS, FOR OPEN SPACE PURPOSES AND ARE THE PERPETUAL MAINTENANCE OBLIGATION OF SAID ASSOCIATION, ITS SUCCESSORS AND ASSIGNS, WITHOUT RECOURSE TO PALM BEACH COUNTY.

IN WITNESS WHEREOF, THE ABOVE-NAMED LIMITED PARTNERSHIP HAS CAUSED THESE PRESENTS TO BE SIGNED BY ITS GENERAL PARTNER, TOLL FL GP CORP., A FLORIDA CORPORATION, LICENSED TO DO BUSINESS IN THE STATE OF FLORIDA, THIS 8th DAY OF August, 2001.

TBI/PALM BEACH LIMITED PARTNERSHIP, A FLORIDA LIMITED PARTNERSHIP

BY: *[Signature]* TOLL FL GP CORP., A FLORIDA CORPORATION, GENERAL PARTNER

BY: *[Signature]* EDWARD D. WEBER VICE PRESIDENT

WITNESS: *[Signature]*

WITNESS: *[Signature]*

STATE OF FLORIDA
COUNTY OF PALM BEACH

BEFORE ME PERSONALLY APPEARED JOSEPH PEASE, WHO IS PERSONALLY KNOWN TO ME, AND WHO EXECUTED THE FOREGOING INSTRUMENT AS VICE PRESIDENT OF THE MIZNER COUNTRY CLUB MASTER ASSOCIATION, INC., A CORPORATION, AND SEVERALLY ACKNOWLEDGED TO AND BEFORE ME THAT HE EXECUTED SUCH INSTRUMENT AS SUCH OFFICER OF SAID CORPORATION, AND THAT THE SEAL AFFIXED TO THE FOREGOING INSTRUMENT IS THE CORPORATE SEAL OF SAID CORPORATION AND THIS IT WAS AFFIXED TO SAID INSTRUMENT BY DUE AND REGULAR CORPORATE AUTHORITY, AND THAT SAID INSTRUMENT IS THE FREE ACT AND DEED OF SAID CORPORATION.

WITNESS MY HAND AND OFFICIAL SEAL THIS 8th DAY OF August, 2001.

MY COMMISSION EXPIRES: 3-14-2005 *[Signature]* NOTARY PUBLIC

ACKNOWLEDGMENTS

STATE OF PENNSYLVANIA
COUNTY OF MONTGOMERY

BEFORE ME PERSONALLY APPEARED EDWARD D. WEBER, WHO IS PERSONALLY KNOWN TO ME, AND WHO EXECUTED THE FOREGOING INSTRUMENT AS VICE PRESIDENT OF TOLL FL GP CORP., A CORPORATION, GENERAL PARTNER OF TBI/PALM BEACH LIMITED PARTNERSHIP, A FLORIDA LIMITED PARTNERSHIP, AND SEVERALLY ACKNOWLEDGED TO AND BEFORE ME THAT HE EXECUTED SUCH INSTRUMENT AS SUCH OFFICER OF SAID CORPORATION, AND THAT THE SEAL AFFIXED TO THE FOREGOING INSTRUMENT IS THE SEAL OF SAID CORPORATION AND THAT IT WAS AFFIXED TO SAID INSTRUMENT BY DUE AND REGULAR AUTHORITY, AND THAT SAID INSTRUMENT IS THE FREE ACT AND DEED OF SAID CORPORATION ON BEHALF OF SAID PARTNERSHIP.

WITNESS MY HAND AND OFFICIAL SEAL THIS 8th DAY OF August, 2001.

MY COMMISSION EXPIRES: 3-14-2005 *[Signature]* NOTARY PUBLIC

ACCEPTANCE OF RESERVATIONS

STATE OF FLORIDA
COUNTY OF PALM BEACH

THE MIZNER COUNTRY CLUB, INC., HEREBY ACCEPTS THE DEDICATIONS OR RESERVATIONS TO SAID CORPORATION AS STATED AND SHOWN HEREON, AND HEREBY ACCEPTS ITS MAINTENANCE OBLIGATIONS FOR SAME AS STATED HEREON. DATED THIS 7th DAY OF August, 2001.

MIZNER COUNTRY CLUB, INC., A FLORIDA CORPORATION, NOT FOR PROFIT

BY: *[Signature]* JOSEPH PEASE, VICE-PRESIDENT

WITNESS: *[Signature]*

WITNESS: *[Signature]*

ACKNOWLEDGMENTS

STATE OF FLORIDA
COUNTY OF PALM BEACH

BEFORE ME PERSONALLY APPEARED JOSEPH PEASE, WHO IS PERSONALLY KNOWN TO ME, AND WHO EXECUTED THE FOREGOING INSTRUMENT AS VICE PRESIDENT OF THE MIZNER COUNTRY CLUB, INC., A CORPORATION, AND SEVERALLY ACKNOWLEDGED TO AND BEFORE ME THAT HE EXECUTED SUCH INSTRUMENT AS SUCH OFFICER OF SAID CORPORATION, AND THAT THE SEAL AFFIXED TO THE FOREGOING INSTRUMENT IS THE CORPORATE SEAL OF SAID CORPORATION AND THIS IT WAS AFFIXED TO SAID INSTRUMENT BY DUE AND REGULAR CORPORATE AUTHORITY, AND THAT SAID INSTRUMENT IS THE FREE ACT AND DEED OF SAID CORPORATION.

WITNESS MY HAND AND OFFICIAL SEAL THIS 7th DAY OF August, 2001.

MY COMMISSION EXPIRES: Nov. 5, 2004 *[Signature]* NOTARY PUBLIC

ACCEPTANCE OF RESERVATIONS

STATE OF FLORIDA
COUNTY OF PALM BEACH

THE MIZNER COUNTRY CLUB MASTER ASSOCIATION, INC., HEREBY ACCEPTS THE DEDICATIONS OR RESERVATIONS TO SAID CORPORATION AS STATED AND SHOWN HEREON, AND HEREBY ACCEPTS ITS MAINTENANCE OBLIGATIONS FOR SAME AS STATED HEREON. DATED THIS 7th DAY OF August, 2001.

MIZNER COUNTRY CLUB MASTER ASSOCIATION, INC., A FLORIDA CORPORATION, NOT FOR PROFIT

BY: *[Signature]* JOSEPH PEASE, VICE PRESIDENT

WITNESS: *[Signature]*

WITNESS: *[Signature]*

ACKNOWLEDGMENTS

STATE OF FLORIDA
COUNTY OF PALM BEACH

BEFORE ME PERSONALLY APPEARED JOSEPH PEASE, WHO IS PERSONALLY KNOWN TO ME, AND WHO EXECUTED THE FOREGOING INSTRUMENT AS VICE PRESIDENT OF THE MIZNER COUNTRY CLUB MASTER ASSOCIATION, INC., A CORPORATION, AND SEVERALLY ACKNOWLEDGED TO AND BEFORE ME THAT HE EXECUTED SUCH INSTRUMENT AS SUCH OFFICER OF SAID CORPORATION, AND THAT THE SEAL AFFIXED TO THE FOREGOING INSTRUMENT IS THE CORPORATE SEAL OF SAID CORPORATION AND THIS IT WAS AFFIXED TO SAID INSTRUMENT BY DUE AND REGULAR CORPORATE AUTHORITY, AND THAT SAID INSTRUMENT IS THE FREE ACT AND DEED OF SAID CORPORATION.

WITNESS MY HAND AND OFFICIAL SEAL THIS 7th DAY OF August, 2001.

MY COMMISSION EXPIRES: Nov 5, 2004 *[Signature]* NOTARY PUBLIC

TITLE CERTIFICATION

STATE OF FLORIDA
COUNTY OF PALM BEACH

I, DAVID M. LAYMAN, A DULY LICENSED ATTORNEY IN THE STATE OF FLORIDA DO HEREBY CERTIFY THAT I HAVE EXAMINED THE TITLE TO THE HEREON DESCRIBED PROPERTY; THAT I FIND THE TITLE TO THE PROPERTY IS VESTED IN TBI/PALM BEACH LIMITED PARTNERSHIP, A FLORIDA LIMITED PARTNERSHIP; THAT THE CURRENT TAXES HAVE BEEN PAID; THAT THERE ARE NO MORTGAGES OF RECORD; AND THAT THERE ARE ENCUMBRANCES OF RECORD BUT THOSE ENCUMBRANCES DO NOT PROHIBIT THE CREATION OF THE SUBDIVISION DEPICTED BY THIS PLAT.

DATED: July 27, 2001 BY: *[Signature]* DAVID M. LAYMAN, ATTORNEY AT LAW, LICENSED IN THE STATE OF FLORIDA

TABULATION DATA

(PETITION NO. 87-07(0))

TOTAL AREA	16.753 ACRES
ROAD (TRACT "S-2")	2.346 ACRES
TRACT "G"	1.889 ACRES
TRACT "O-1"	0.006 ACRES
TRACT "O-2"	0.006 ACRES
DENSITY (64 RESIDENTIAL LOTS)	3.82 UNITS/ACRE

COUNTY APPROVAL

COUNTY ENGINEER:

THIS PLAT IS HEREBY APPROVED FOR RECORD PURSUANT TO PALM BEACH COUNTY ORDINANCE NO. 95-33, AND IN ACCORDANCE WITH SEC. 177.071 (2), F.S. THIS 10th DAY OF October, 2001, AND HAS BEEN REVIEWED BY A PROFESSIONAL SURVEYOR AND MAPPER EMPLOYED BY PALM BEACH COUNTY IN ACCORDANCE WITH SEC. 177.081 (1), F.S.

[Signature] GEORGE T. WEBB, P.E. - COUNTY ENGINEER

SURVEYOR'S NOTES:

- DENOTES SET PERMANENT REFERENCE MONUMENTS LB # 4396
 - DENOTES SET PERMANENT CONTROL POINTS LB # 4396
- IN THOSE CASES WHERE EASEMENTS OF DIFFERENT TYPES CROSS OR OTHERWISE COINCIDE, DRAINAGE EASEMENTS SHALL HAVE FIRST PRIORITY, UTILITY EASEMENTS SHALL HAVE SECOND PRIORITY, ACCESS EASEMENTS SHALL HAVE THIRD PRIORITY, AND ALL OTHER EASEMENTS SHALL BE SUBORDINATE TO THESE WITH THEIR PRIORITIES BEING DETERMINED BY USE RIGHTS GRANTED.
- BEARINGS, AS SHOWN HEREON, ARE BASED UPON THE NORTH LINE OF SECTION 29, TOWNSHIP 46 SOUTH, RANGE 42 EAST, PALM BEACH COUNTY, FLORIDA, HAVING A BEARING OF NORTH 89°24'02" EAST, GRID B3, 1990 ADJUSTMENT, AND ALL OTHER BEARINGS ARE RELATIVE THERETO.
- NO BUILDING OR ANY KIND OF CONSTRUCTION OR TREES OR SHRUBS SHALL BE PLACED ON ANY EASEMENT OR WITHIN ANY PRIVATE STREET TRACTS WITHOUT PRIOR WRITTEN CONSENT OF ALL EASEMENT BENEFICIARIES AND ALL APPLICABLE COUNTY APPROVALS OR PERMITS AS REQUIRED FOR SUCH ENCROACHMENTS.
- LEGEND
 - P.B. DENOTES PLAT BOOK
 - P.G.S. DENOTES PAGES
 - R DENOTES RADIUS
 - L DENOTES ARC LENGTH
 - Δ DENOTES DELTA ANGLE
 - C DENOTES CENTERLINE
 - NR DENOTES NON RADIAL LINE
 - P.S.M. DENOTES PROFESSIONAL SURVEYOR AND MAPPER
 - O.R.B. DENOTES OFFICIAL RECORD BOOK
 - F.N.D. DENOTES FOUND
 - P.B.C. DENOTES PALM BEACH COUNTY
 - L.M.E. DENOTES LAKE MAINTENANCE EASEMENTS
 - U.E. DENOTES UTILITY EASEMENT
 - RL DENOTES RADIAL LINE
 - D.E. DENOTES DRAINAGE EASEMENT
 - L.A.E. DENOTES LIMITED ACCESS EASEMENTS
 - L.B.E. DENOTES LANDSCAPE BUFFER EASEMENTS
 - CB DENOTES CHORD BEARING
 - P.S.U.E. DENOTES PRIVATE SPECIFIC USE EASEMENT
 - C DENOTES CHORD LENGTH
 - L.M.A.E. DENOTES LAKE MAINTENANCE ACCESS EASEMENTS
 - R.E. DENOTES ROOF OVERHANG AND RECIPROCAL MAINTENANCE EASEMENTS
- BEARINGS SHOWN HEREON ARE TO BE ASSUMED AS NON-RADIAL UNLESS OTHERWISE NOTED AS RADIAL.

SURVEYOR'S CERTIFICATION

STATE OF FLORIDA
COUNTY OF PALM BEACH

THIS IS TO CERTIFY THAT THE PLAT SHOWN HEREON IS A TRUE AND CORRECT REPRESENTATION OF A SURVEY MADE UNDER MY RESPONSIBLE DIRECTION AND SUPERVISION; THAT SAID SURVEY IS ACCURATE TO THE BEST OF MY KNOWLEDGE AND BELIEF; THAT PERMANENT REFERENCE MONUMENTS (P.R.M.'S) HAVE BEEN PLACED AS REQUIRED BY LAW, AND THAT PERMANENT CONTROL POINTS (P.C.P.'S) AND MONUMENTS ACCORDING TO SEC. 177.091 (9), F.S., WILL BE SET UNDER THE GUARANTEES POSTED WITH THE PALM BEACH COUNTY BOARD OF COUNTY COMMISSIONERS FOR THE REQUIRED IMPROVEMENTS; AND, FURTHER, THAT THE SURVEY DATA COMPLIES WITH ALL THE REQUIREMENTS OF CHAPTER 177 FLORIDA STATUTES, AS AMENDED, AND THE ORDINANCES OF PALM BEACH COUNTY, FLORIDA.

DATE: Aug. 28, 2001 *[Signature]* CRAIG S. PUSEY, PROFESSIONAL SURVEYOR AND MAPPER, FLORIDA CERTIFICATE NO. 5019, LANDMARK SURVEYING AND MAPPING, INC., 1850 FOREST HILL BLVD. SUITE 100, WEST PALM BEACH, FLORIDA 33406

NOTICE: THIS PLAT, AS RECORDED IN ITS GRAPHIC FORM, IS THE OFFICIAL DEPICTION OF THE SUBDIVIDED LANDS DESCRIBED HEREIN AND WILL IN NO CIRCUMSTANCES BE SUPPLANTED IN AUTHORITY BY ANY OTHER GRAPHIC OR DIGITAL FORM OF THE PLAT. THERE MAY BE ADDITIONAL RESTRICTIONS THAT ARE NOT RECORDED ON THIS PLAT THAT MAY BE FOUND IN THE PUBLIC RECORDS OF THIS COUNTY.

THIS INSTRUMENT WAS PREPARED BY LESLIE C. BISPOTT, P.S.M. UNDER THE SUPERVISION OF CRAIG S. PUSEY, P.S.M. OF LANDMARK SURVEYING AND MAPPING, INC.

TOLL FL GP CORP.

NOTARY

MIZNER COUNTRY CLUB, INC.

NOTARY

MIZNER COUNTRY CLUB MASTER ASSN. INC.

NOTARY

COUNTY ENGINEER

SURVEYOR

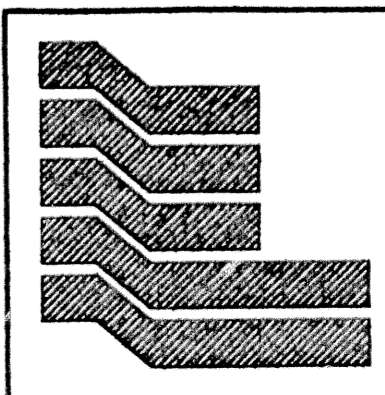
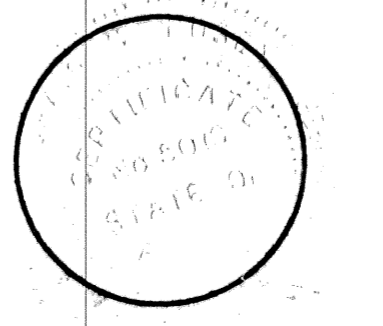
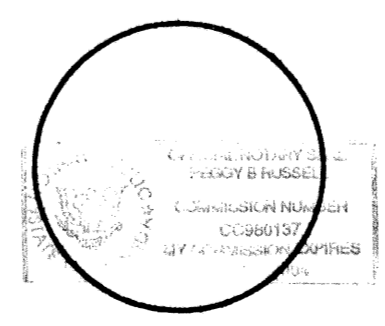
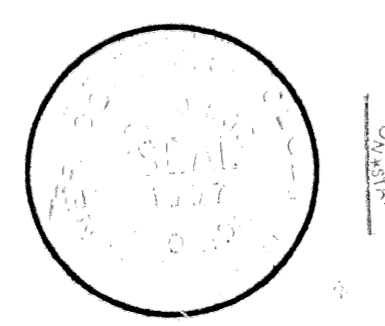
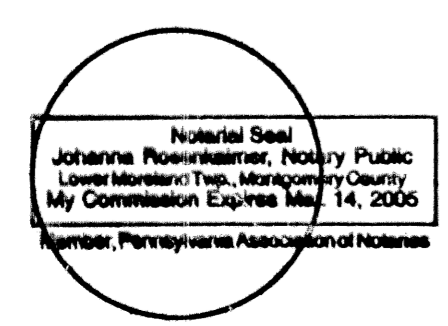

Landmark Surveying & Mapping Inc.
1850 Forest Hill Boulevard
Ph. (561) 433-5405 Suite 100 W.P.B. Florida
LB # 4396

DELRAY TRAINING CENTER P.U.D.-PARCEL G